

QUITE SOFTWARE

TECHNICAL SUPPORT

Innovative PDF Solutions

DOUBLE SIDED CUT STACKS...

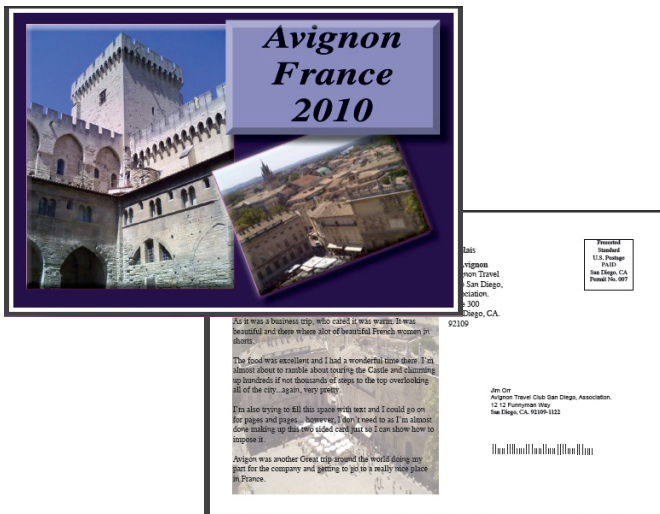

- 1) Open your PDF Document

In this Example I have opened a 96 Page PDF document and I would like to Create a 4up Double Sided Cut Stacks. When Complete you can cut the sheet and stack them on top of each other and these pages Will be consecutive (e.g. The PDF started with pages numbered 1 front-1 back, 2 front 2 back, etc...)

Note: I have chosen to make this signature with "Double Cut Stacks". If you are unfamiliar with his printing term please review your Quite Imposing Guide for clarification.

Also Note: In this layout (shown here) the customer wanted a specific Signature Rule to have the backs of the cards line up with the fronts - Remember, the Rule you create in Shuffle pages dictates the placement of pages in your signature.

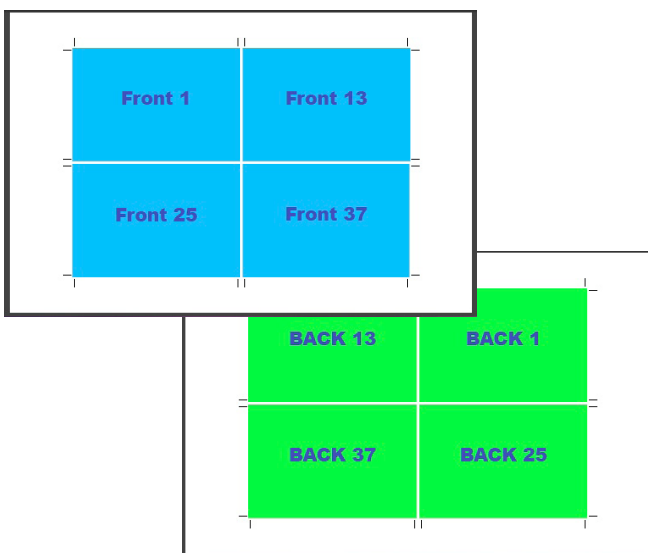

Desired Layout

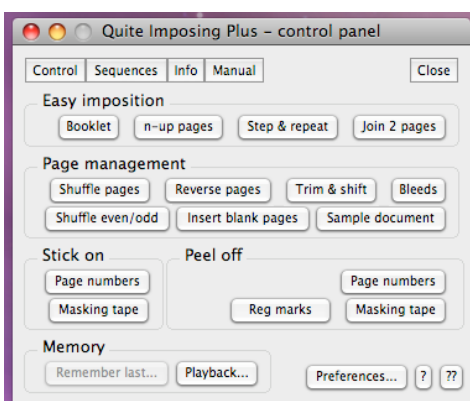

- 2) To access Quite Imposing Plus, simply Select >**Plug-ins** and then >**Quite Imposing Plus** from Acrobat's **Menu bar**. Alternately, selecting >**Plug-ins** from the **Menu bar** and then >**Quite Imposing Plus** >**Imposition Control Panel** as shown here.

- 3) Click **Shuffle pages..** button
A dialog box will appear.

Note: In this dialog we will ask you a series of questions and give you options that will work best for the particular job you are running.

QUITE SOFTWARE

TECHNICAL SUPPORT

Innovative PDF Solutions

DOUBLE SIDED CUT STACKS... Continued

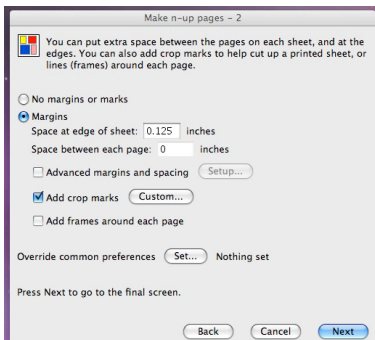
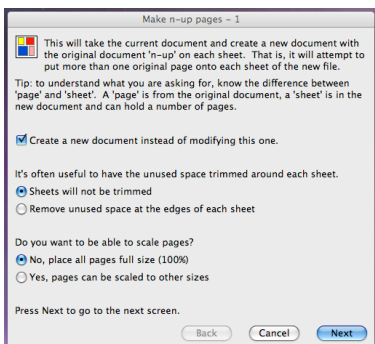
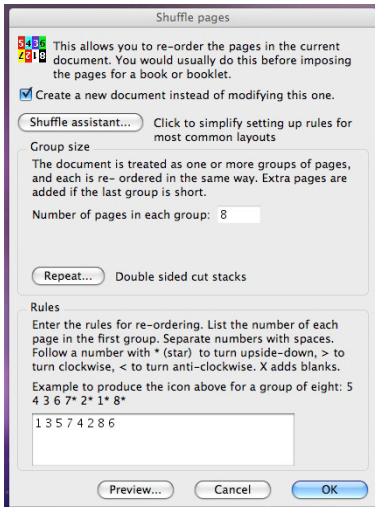
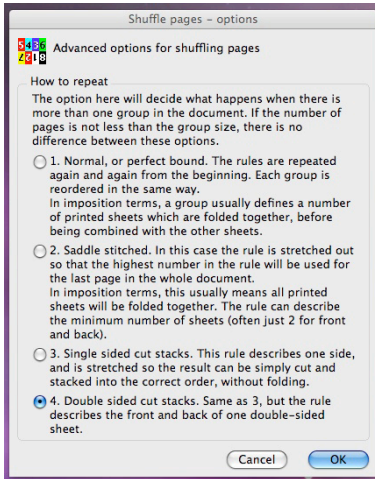

- 4) In this Example I've Selected Number of pages in Each Group 8
- 5) Click on **Repeat...** button
A dialog box will appear (not shown here).
Select **4. Double sided cut stacks.**
Click **OK** button to get back to Shuffle pages Dialog box.
- 6) Now, in the **Rules** section type in **1 3 5 7 4 2 8 6**

Note: Don't forget to put space after each number.

- 7) Click **OK** button to continue

- 8) Now Select **n-up pages...** button
A dialog box will appear.

Select

- Sheets will no be trimmed
- No, place all pages full size (100%)

- 9) Click **Next** button to continue
A dialog box will appear.

In this Example I have selected

- Margins
- Space at edge of Sheet 0.125 inches

I Also, Checked Add Crop marks

- 10) Click **Next** button to continue
A dialog box will appear.

QUITE SOFTWARE

TECHNICAL SUPPORT

Innovative PDF Solutions

DOUBLE SIDED CUT STACKS... Continued

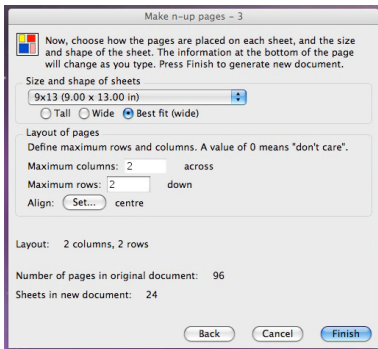

In this Example I have selected Size and shape of Sheets to be a specific size. Also, selected Best fit tall and Aligned Centre.

Note: If you don't see the size you need in the Defaults just go to More Choices and add the size you need.

11) Click the **Finish** button

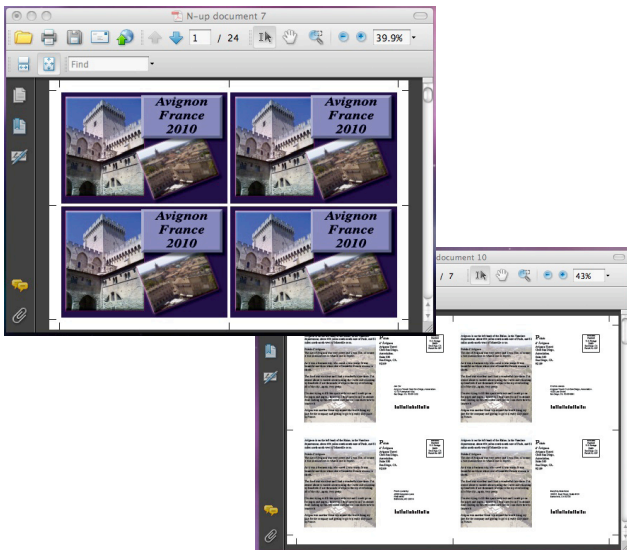

Note: You can now see the finished piece and are able to Print or Save your Double Cut Stacks.

Final Note: If you need any help setting up your particular signature, Please review our on-line help manual or contact us at help@quite.com.

We will be happy to assist you.

– Quite Software Technical Support Team
www.quite.com

